

COATINGS:

FRAMEWORK-COATED PER (ASTM-F-1043) TYPE A

BENDING FORCE ON THE X-X AXIS:

LINE POST=274 LBS @ 6'-0" ABOVE GRADE

DRIVING OPTIONS:

IF POST ARE DRIVEN IN LIEU OF CONCRETE SET, DRIVE 3' MIN. INTO THE GROUND.

POST HEIGHT ABOVE GROUND:

MAX PICKET HEIGHT FOR STANDARD C POST IS 6'-0".

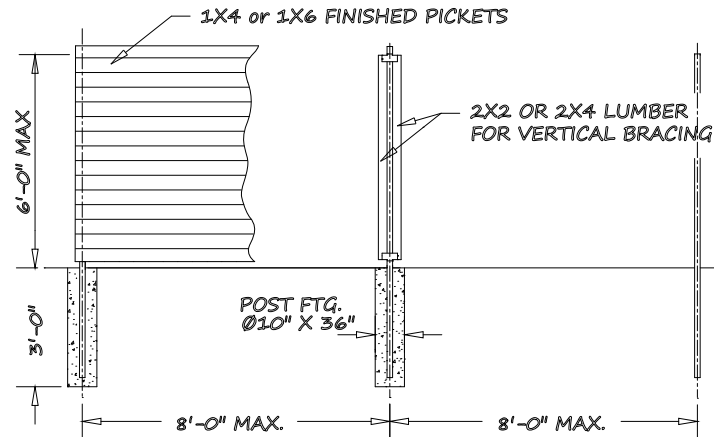

LINE POST CONN. (BOTTOM)

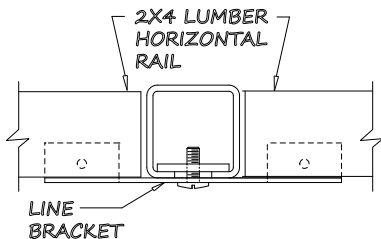

LINE POST CONN. (TOP)

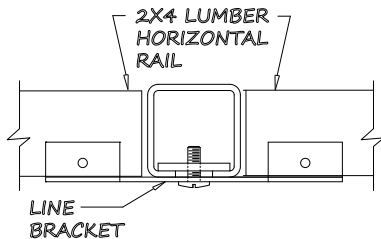

CORNER CONN. (BOTTOM)

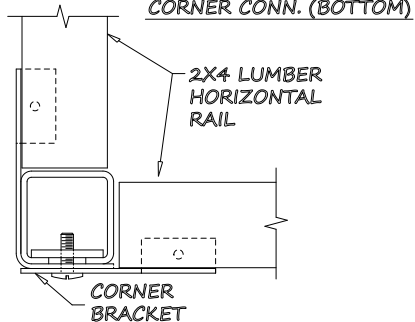

CORNER CONN. (TOP)

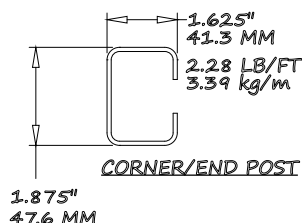
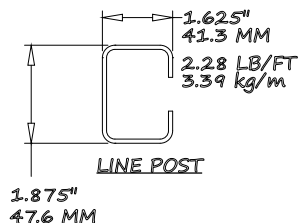
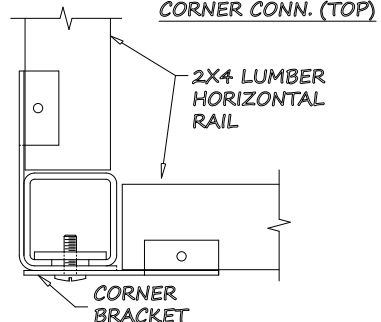

ITEM	QNTY	DESCRIPTION		MATERIAL
		MACHINING TOLERANCES		FABRICATION TOLERANCES
SCALE	NONE	CHK'D BY	DTM	UNDER 18" ± 1/32
DWN BY		DTM01-11-17		18" AND OVER ± 1/16
		APP'D BY		ALL MACHINED SURFACES ± 1/64
				BREAK ALL SHARP EDGES

STANDARD 'C' - HORIZONTAL PICKETS-WOOD

CAD FILENAME:
FENCE 4-21
LAST PLOT DATE:
09/11/17

GREGORY
FENCE
4100 13th Street SW
Canton, Ohio 44710

REF. No.
DRWG No.
FENCE 4-21