

COATINGS:

FRAMEWORK-COATED PER (ASTM-F-1043) TYPE A

BENDING FORCE ON THE X-X AXIS:

LINE POST=263 LBS @ 6'-0" ABOVE GRADE

LINE POST=263 LBS @ 8'-0" ABOVE GRADE

DRIVING OPTIONS:

IF POST ARE DRIVEN IN LIEU OF CONCRETE SET, DRIVE 3' MIN. INTO THE GROUND.

POST HEIGHT ABOVE GROUND:

MAX PICKET HEIGHT FOR STANDARD C POST IS 6'-0".

MAX PICKET HEIGHT FOR HEAVY C POST IS 8'-0".

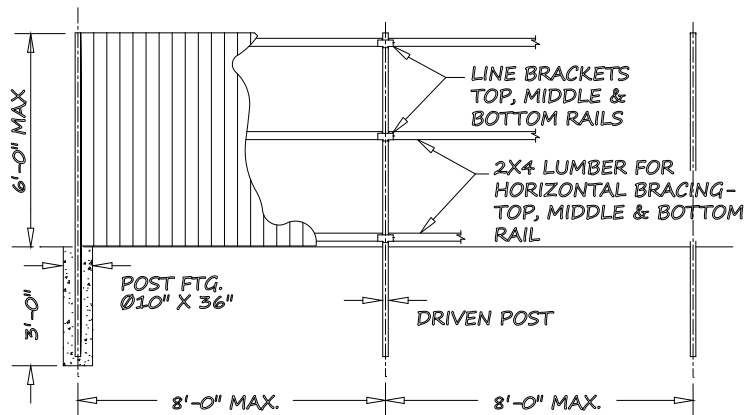

DOG EAR - STYLE

SHADOW BOX - STYLE

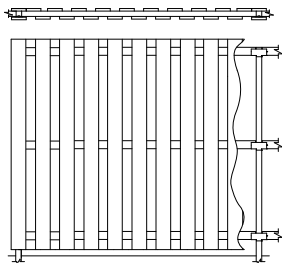
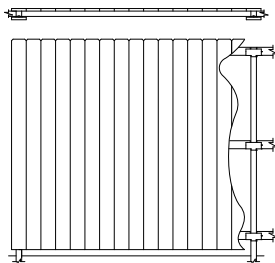

BOARD ON BOARD - STYLE

HORIZONTAL - STYLE

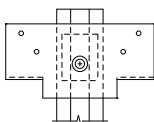
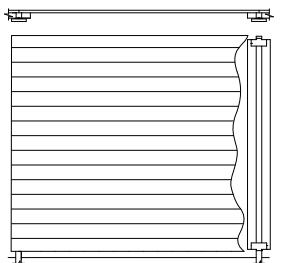
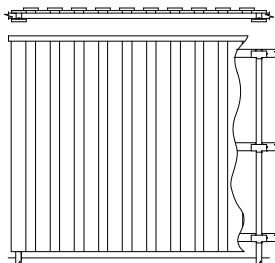

LINE BRACKET

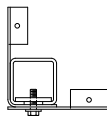

CORNER BRACKET

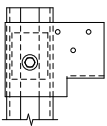

END BRACKET

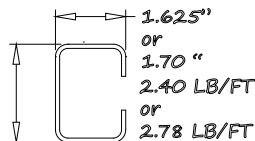

LINE POST

1.875"
or
2.25"

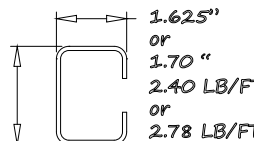

CORNER/END POST

1.875"
or
2.25"

ITEM	QNTY	DESCRIPTION	MACHINING TOLERANCES		FABRICATION TOLERANCES	
SCALE	NONE	CHK'D BY DTM	0.1	± 0.030	UNDER 18"	± 1/32
DWN BY	DTM	01/30/20	0.01	± 0.015	18" AND OVER	± 1/16
		APP'D BY	ANGLES	± 0.005	ALL MACHINED SURFACES 15° BREAK ALL SHARP EDGES	

TRADITIONAL FENCE STYLES - WOOD

CAD FILENAME:
FENCE 4-45
LAST PLOT DATE:
01/30/20



4100 13th Street SW
Canton, Ohio 44710

REF. No.
DRWG No.

FENCE 4-45