

RAIL TIE SPACING 24"

1"-7 EXPANDED METAL OR
3/4"-9 EXPANDED METAL
REVERSED DIAMOND

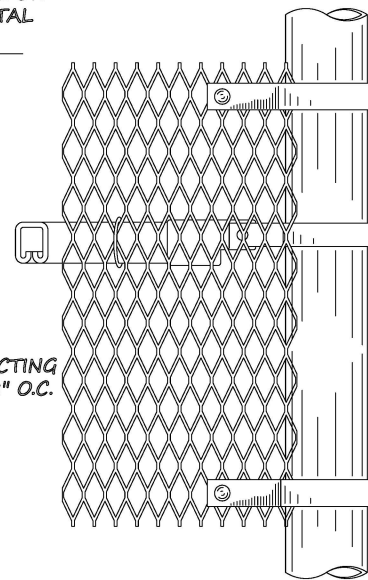
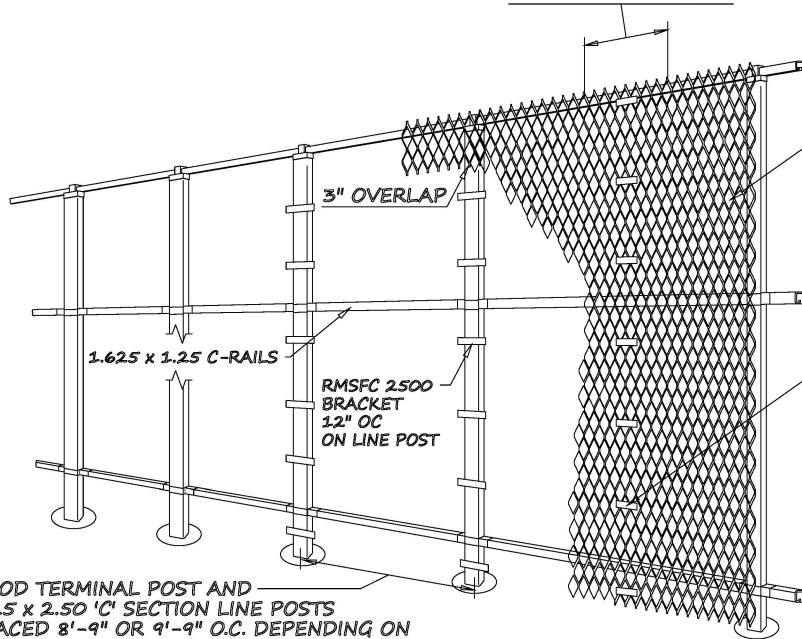

CORNER CONNECTION

4" OD TERMINAL POST AND
3.25 x 2.50 'C' SECTION LINE POSTS
SPACED 8'-9" OR 9'-9" O.C. DEPENDING ON
PANEL SIZE

10 GA. x 1" MINIMUM FLAT BAR RMSFC 2500
FORMED AS SHOWN

5/16-16 UNC x 1-1/2 LG.
CARRIAGE BOLTS AND NUTS
2 REQUIRED PER CLAMP

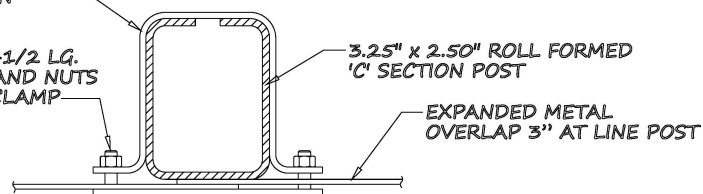

10 GA. x 1" MINIMUM FLAT BAR
RMSFC 325

SQUARE HOLES
THIS SIDE TYP.

ITEM	QNTY	DESCRIPTION		MACHINING TOLERANCES		FABRICATION TOLERANCES	
SCALE	NONE	CHK'D BY	DTM	0.1	± 0.030	UNDER 18"	± 1/32
				0.01	± 0.015	18" AND OVER	± 1/16
DWN BY	DTM	08-14-17	APP'D BY	0.005	± 0.005	ALL MACHINED SURFACES	± 1/48
				ANGLES	± 1/48	BREAK ALL SHARP EDGES	

SUPER 'C' - w/o BARB WIRE, ROUND TERM. PANEL
CLAMPS (EXPANDED METAL)

CAD FILENAME:
FENCE 4-5
LAST PLOT DATE:
08/14/17

GREGORY
FENCE
4100 13th Street SW
Canton, Ohio 44710

REF. No.
DRWG No.
FENCE 4-5