



G-STRUT 4100 13th Street SW, Canton OH 44710

Phone: 866.997.8788 – Fax: 330.477.0626

www.gregorystrut.com

CENTER LOAD BEAM CLAMP – SERIES W220

-STANDARD DUTY-

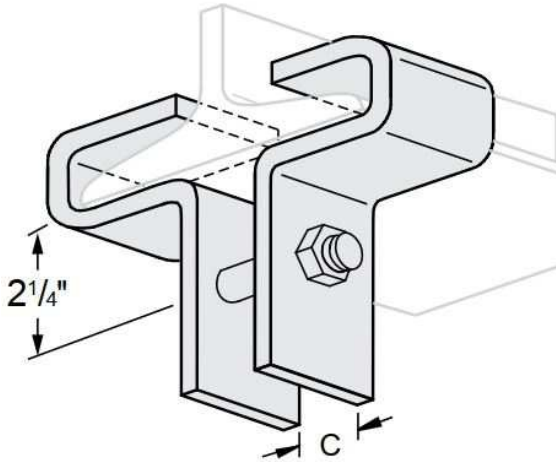

Size Range: See maximum recommended load table.

Material: Low Carbon Steel.

Finish: Plain.

Ordering: Specify type number; width of flange; flange thickness; series # and finish.

Approvals: Complies with Federal Specification A-A-1192A (Type 21) and Manufacturers Standardization Society SP-69 (Type 21).

Function: Designed to be used in the suspension of a hanger rod from the center of an I-beam. The clamp's design allows the load to be distributed equally on either side of the beam. Normally used in conjunction with W715-Series weldless eye nut.

Available In: 304 & 316 Stainless Steel

All beam clamps are plain steel.
To order other finishes, change the 5th character in the Part # as seen below:
STAINLESS STEEL (304) = 8
STAINLESS STEEL (316) = 0
Example: **W220 2 12** = STAINLESS STEEL
8

PART #	TYPE NUMBER	FLANGE WIDTH	BOLT SIZE	SIZE (C)	MATERIAL SIZE	MAXIMUM FLANGE THICKNESS	MAXIMUM RECOMMENDED LOAD(lbs.)	CARTON QTY.	LBS./ 100pcs
W220112	1	2	3/8	1/2"	3ga. x 1-1/4"	7/16"	1000	BULK	63
W220122	2	2	1/2	1/2"	3ga. x 1-1/4"	7/16"	1250	BULK	84
W220132	3	2	1/2	5/8"	3/8" x 1-1/2"	7/16"	1500	BULK	128
W220113	1	3	3/8	1/2"	3ga. x 1-1/4"	7/16"	1000	BULK	85
W220123	2	3	1/2	1/2"	3ga. x 1-1/4"	7/16"	1250	BULK	93
W220133	3	3	1/2	5/8"	3/8" x 1-1/2"	7/16"	1500	BULK	142
W220114	1	4	3/8	1/2"	3ga. x 1-1/4"	1/2"	1000	BULK	88
W220124	2	4	1/2	1/2"	3ga. x 1-1/4"	1/2"	1250	BULK	110
W220134	3	4	1/2	5/8"	3/8" x 1-1/2"	1/2"	1500	BULK	163

PROJECT INFORMATION	APPROVAL STAMP
Project:	Notes:
Address:	
Contractor:	
Engineer:	
Date:	
Approved <input type="checkbox"/> Approved as Noted <input type="checkbox"/> Not Approved <input type="checkbox"/>	