



G-STRUT 4100 13th Street SW, Canton OH 44710

Phone: 866.997.8788 – Fax: 330.477.0626

www.gregorystrut.com

WELDED BEAM ATTACHMENT – SERIES W740

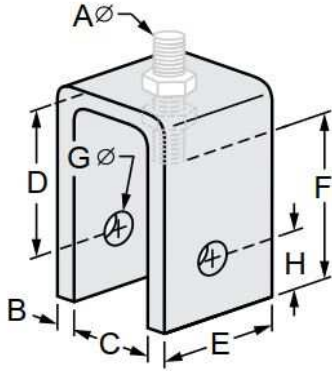

- Size Range:** 3/8" through 2-1/4" rod sizes
Material: Carbon Steel.
Finish: Plain.
Ordering: Specify rod size, series # and finish.
Function: Designed as a support, guide, or anchor for heavy loads.
Available In: Electro-Galvanized, 304 & 316 Stainless Steel.

PART #	ROD SIZE (A)	HOLE SIZE (G)	SIZE (B)	SIZE (C)	SIZE (D)	SIZE (E)	SIZE (F)	SIZE (H)	BOLT SIZE	MAXIMUM REC. LOAD(lbs.)		LBS./100pcs
										650 F	750 F	
W740103	3/8"	1/2"	1/4"	1-1/4"	2"	2"	7/8"	3/8"	1/2 x 2-1/2"	610	510	117
W740104	1/2"	5/8"	1/4"	1-1/4"	2"	2"	7/8"	3/8"	5/8 x 2-1/2"	1130	940	131
W740105	5/8"	3/4"	1/4"	1-1/4"	2"	2"	7/8"	3/8"	3/4 x 2-3/4"	1810	1510	155
W740106	3/4"	1"	3/8"	1-7/8"	2"	2-1/2"	1-1/8"	3/8"	7/8 x 3-1/2"	2710	2660	279
W740107	7/8"	1-1/8"	3/8"	2"	3"	2-1/2"	1-1/4"	3/8"	1 x 4"	3770	3150	394
W740110	1"	1-1/4"	1/2"	2"	3"	3"	1-1/2"	3/8"	1-1/8 x 4-1/2"	4960	4150	629
W740112	1-1/4"	1-1/2"	5/8"	2-1/2"	3"	4"	2"	1/2"	1-3/8 x 5"	8000	6660	1022
W740114	1-1/2"	1-3/4"	3/4"	3"	4"	5"	2-1/2"	1/2"	1-5/8 x 5-3/4"	11630	9700	1902
W740116	1-3/4"	2"	3/4"	3-3/4"	5"	5"	2-3/4"	1/2"	1-7/8 x 6-7/8"	15700	14000	2418
W740120	2"	2-3/8"	3/4"	3-3/4"	5"	6"	3-1/4"	1/2"	2-1/4 x 6-7/8"	20700	18460	3055
W740122	2-1/4"	2-5/8"	3/4"	4-1/4"	6"	6"	3-1/2"	1/2"	2-1/2 x 7-3/8"	27200	24260	3678

All above beam attachments are plain steel. To order other finishes, change the 5th character in the Part # as seen below:

STAINLESS STEEL (304) = 8

STAINLESS STEEL (316) = 0

ELECTRO-GALVANIZED = 2

Example: **W740103** = ELECTRO-GALV
2

PROJECT INFORMATION	APPROVAL STAMP
Project:	Notes:
Address:	
Contractor:	
Engineer:	
Date:	
Approved <input type="checkbox"/> Approved as Noted <input type="checkbox"/> Not Approved <input type="checkbox"/>	