



## & WIZARD® ACCESSORIES



**Installation  
Is A Wiz**



# Wizard™ Accessories

Works with hundreds of applications and interchangeable framing systems including: Electrical/Conduit, Plumbing, Mechanical, Pipe, PVC, Schedule 40, Copper, Hydraulic Tubing, Stainless Steel Pipe & Tube, Chemical, Food, Waste Water, etc...A multitude of versatile applications.

## Channels

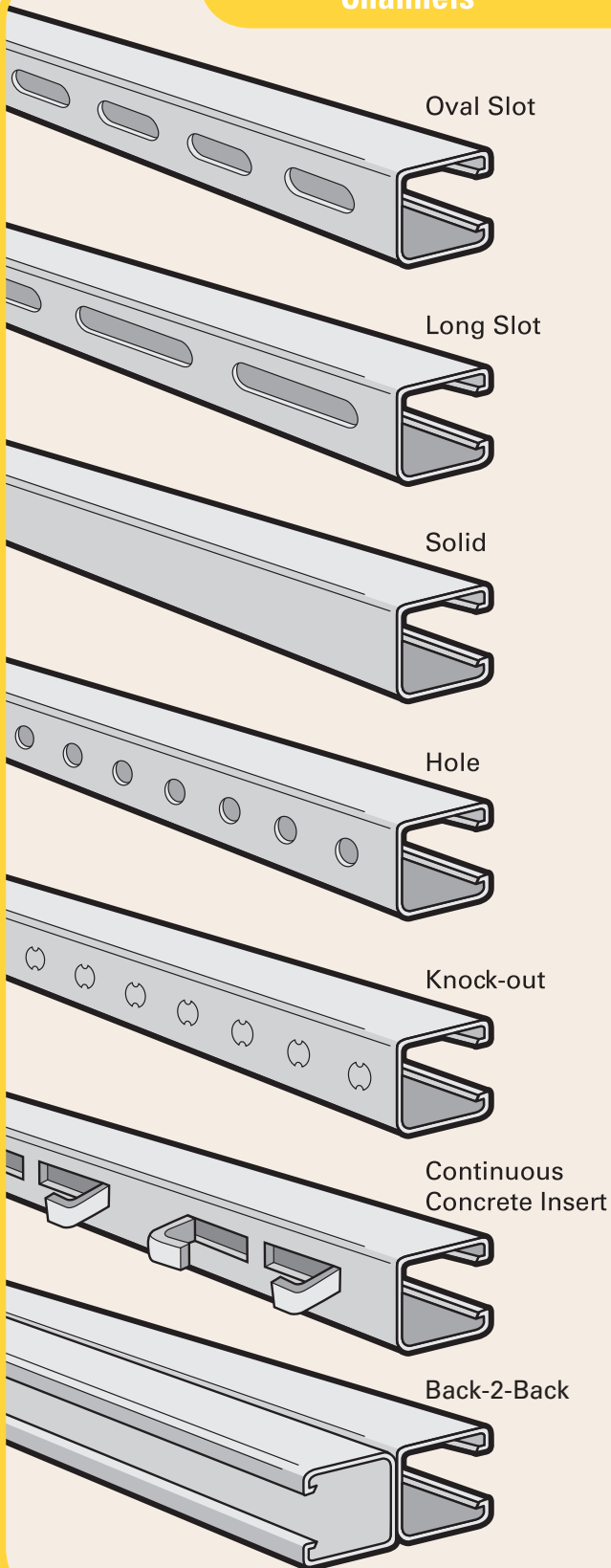

## Common Fittings

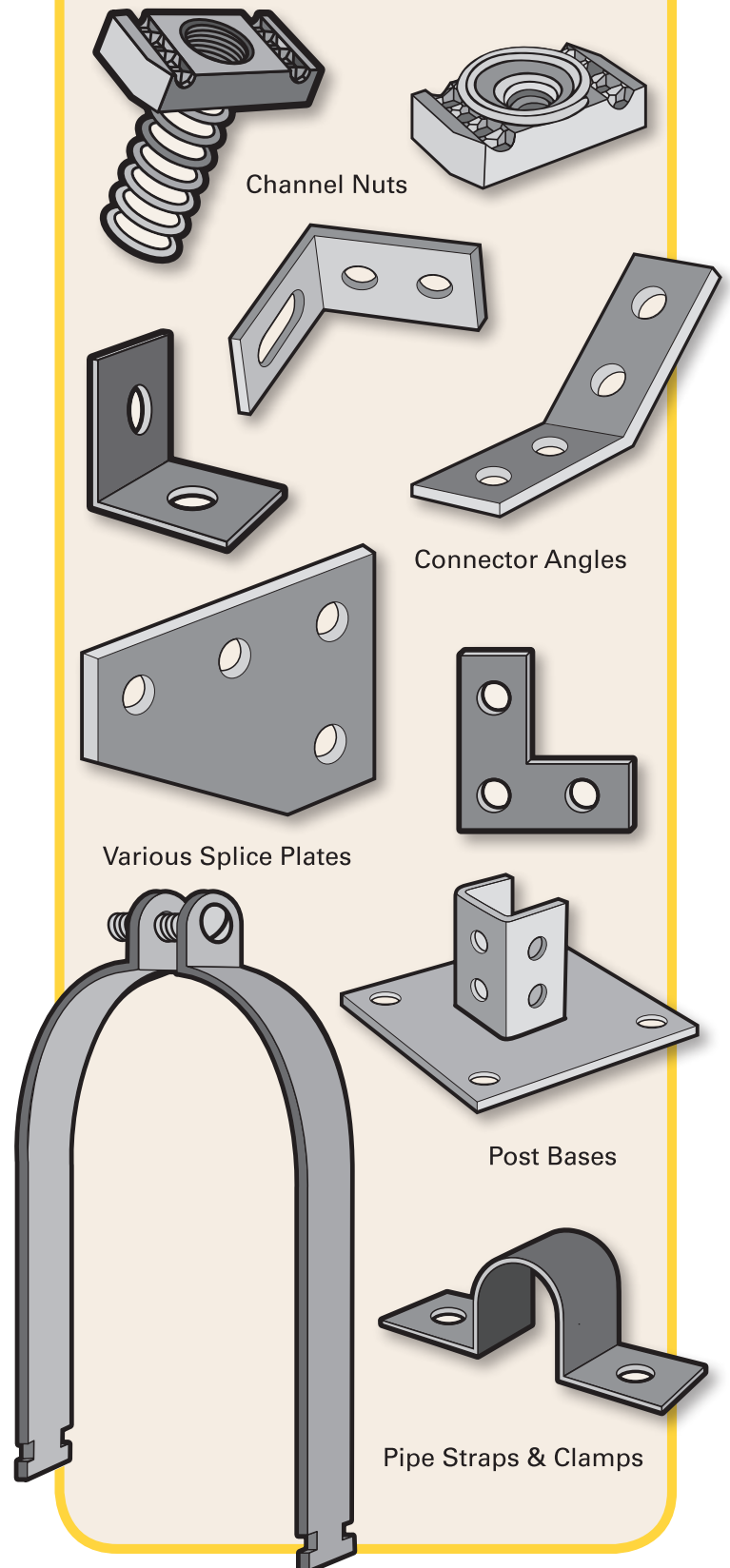

# B

# 1

## Simple Strut

Hundreds of fittings  
for practically any  
contingency.

Radiused corner  
spring nuts  
insert and turn  
easily.

Case hardened  
nut teeth grip the  
channel's inner  
edge.

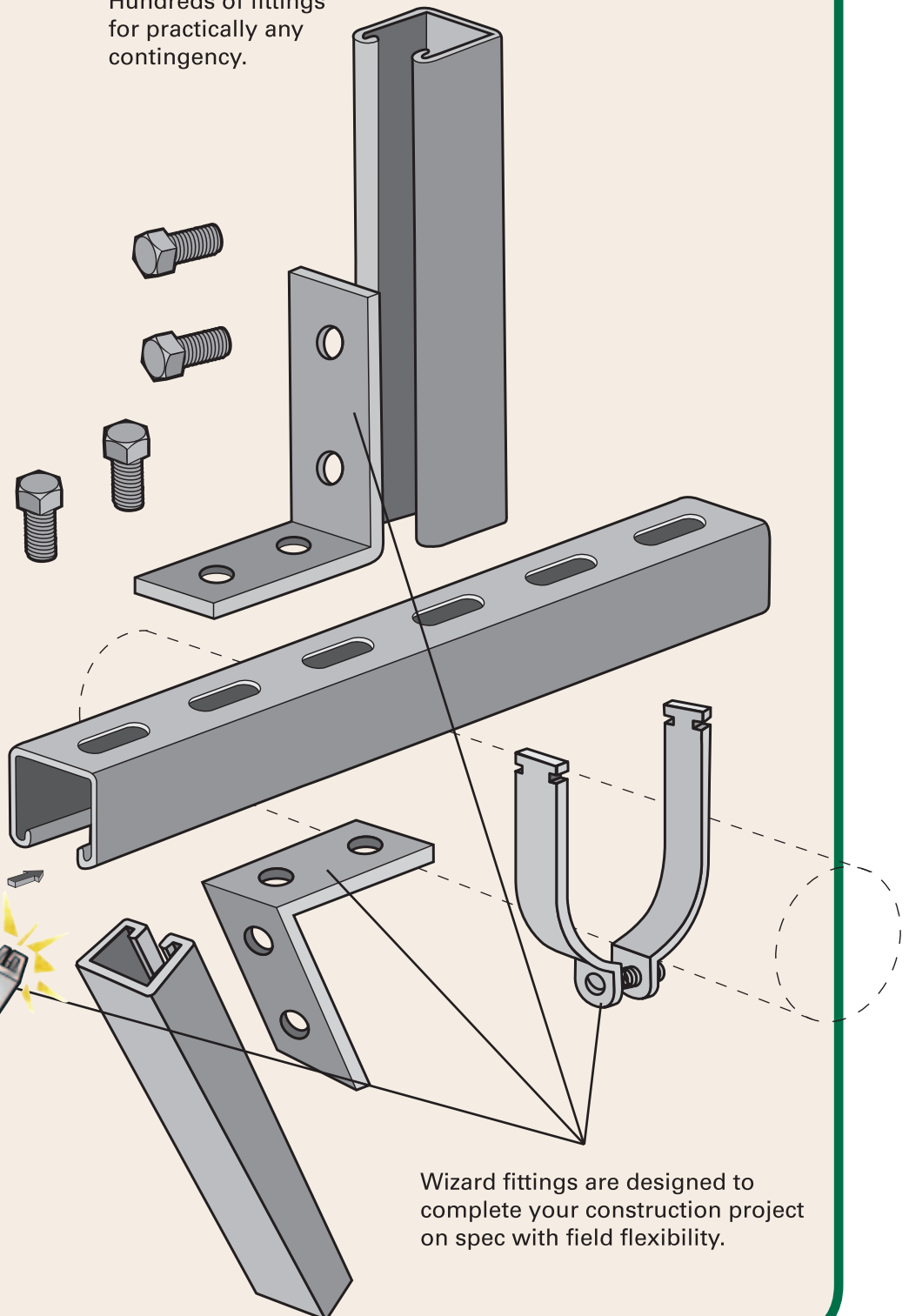

Wizard fittings are designed to  
complete your construction project  
on spec with field flexibility.



**B****2**

### Utility Stands

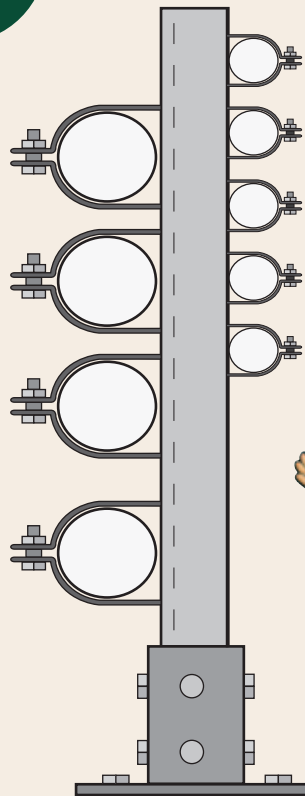

Strut can be configured into functional equipment service stands.



### Panel Supports

Panel supports can be configured into a variety of support applications and attached to existing structurals for stationary or overhead mounting of panel boards, electronics, machinery, HVAC, etc.

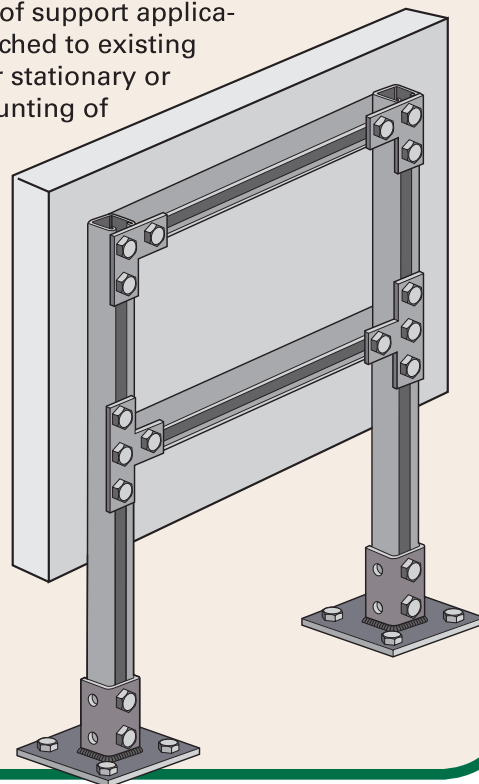
**B****3**

## Suspended Support Configurations

**SS****1**

### Beam Clamp Support

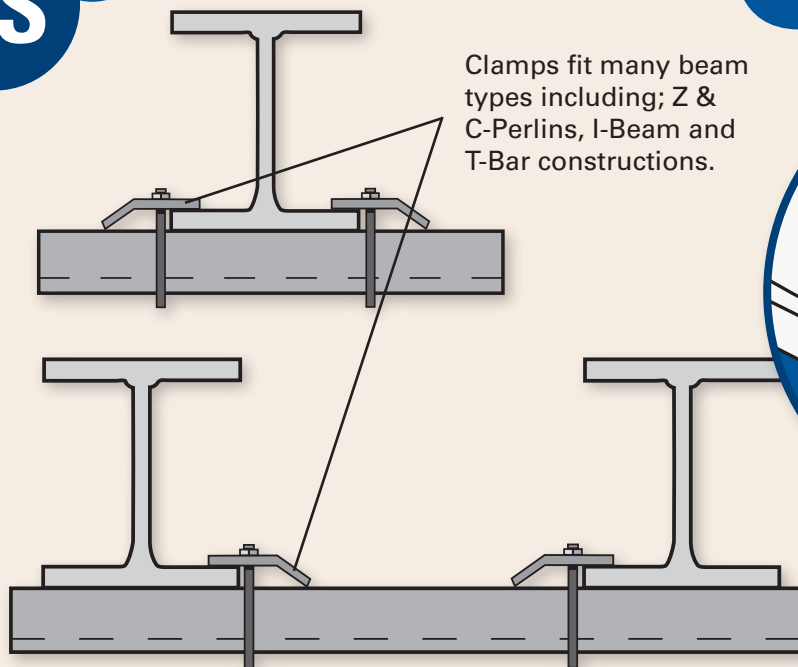

Clamps fit many beam types including; Z & C-Perlins, I-Beam and T-Bar constructions.

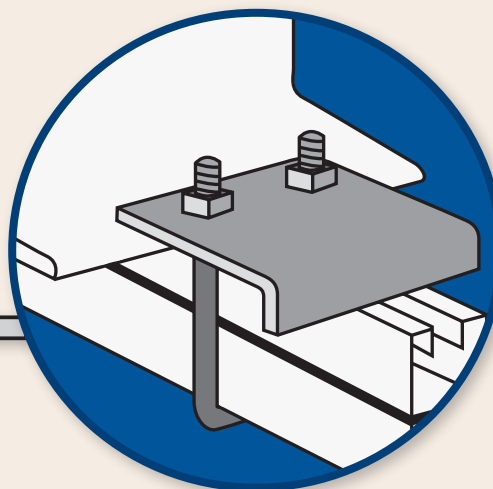

Beam Clamp Supports can be attached to various sized widths of "I-Beams" and flange thicknesses.

## Trapeze

SS

2

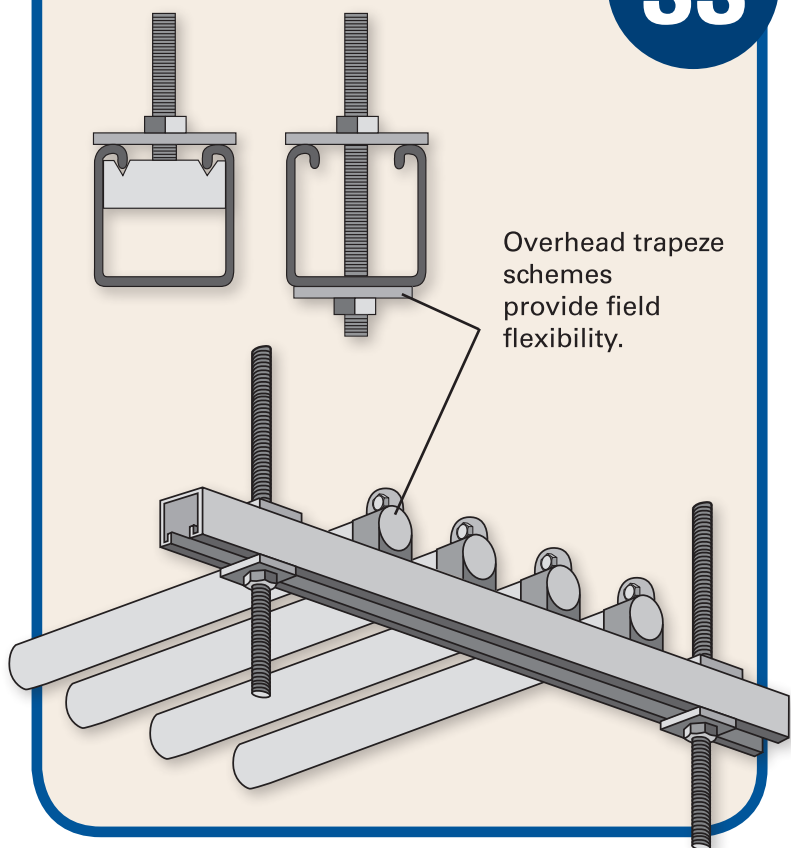

## Complex Made Easy

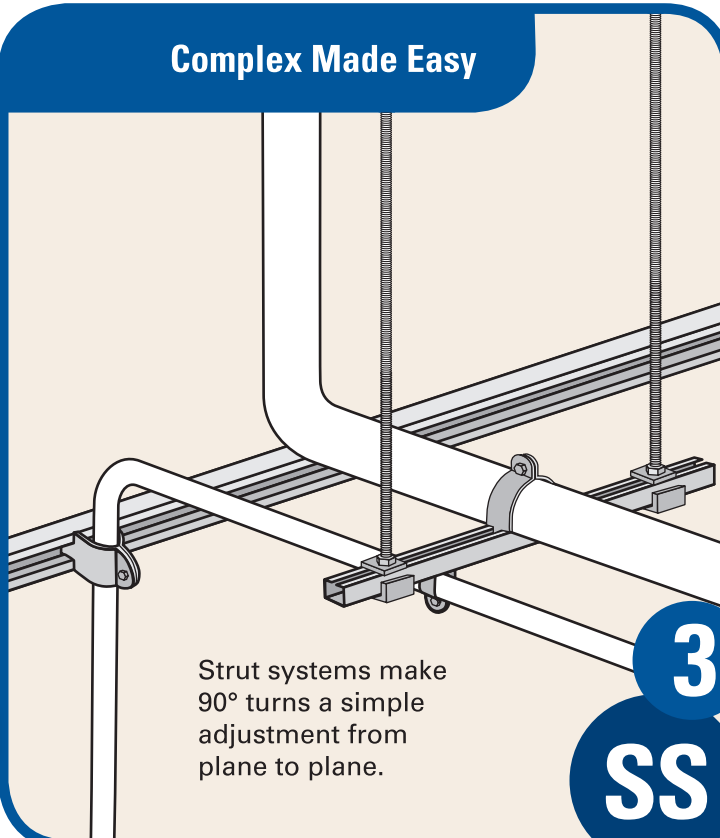

3

SS

## Wall Mount Configurations

### Shelving & Shelf Brackets

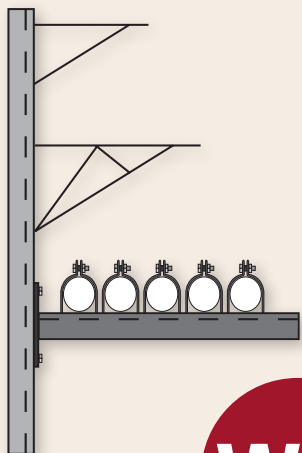

2

WM

### Typical Wall Mount

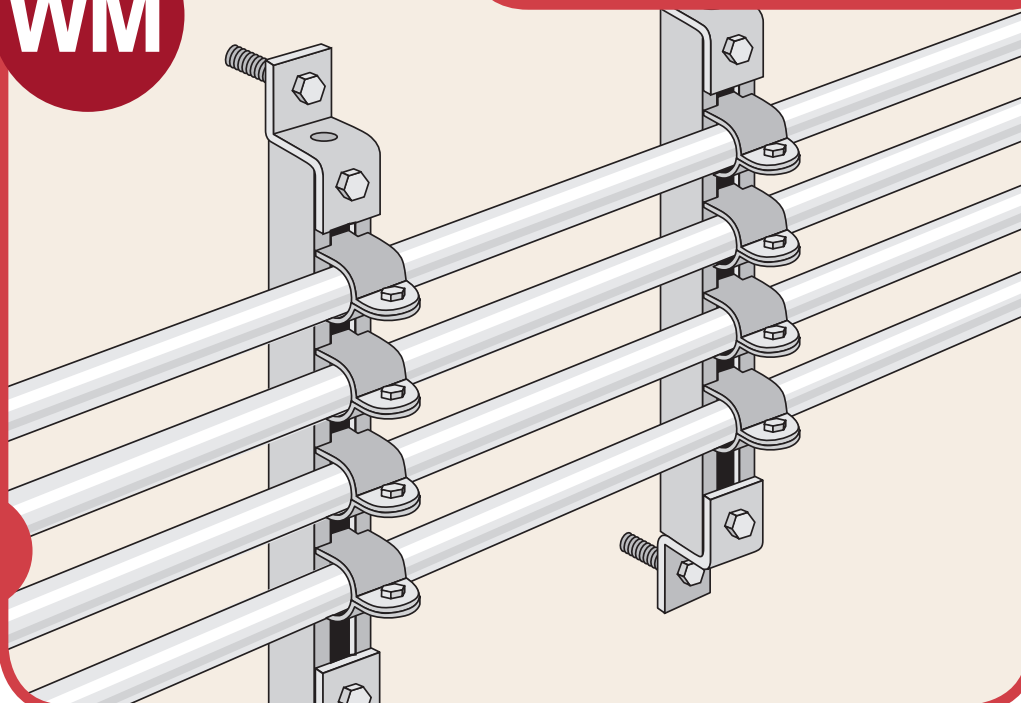

1

WM

# A WIZ TO ADAPT IN THE FIELD

JUST A FEW SIMPLE TOOLS NEEDED

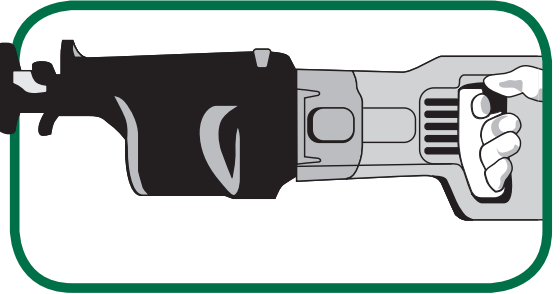
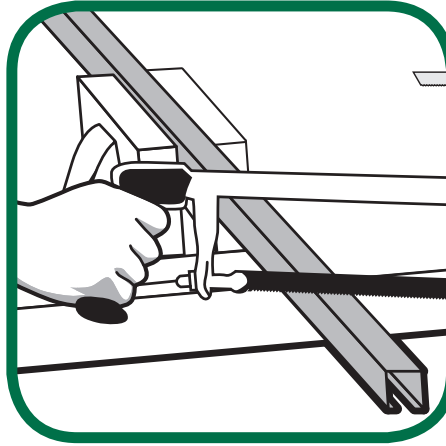
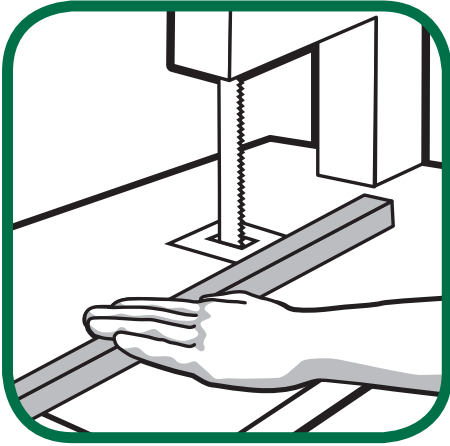

EASY CUTTING IN FIELD WITH PROPER SAWING EQUIPMENT  
INSTALLS WITH COMMON SOCKETS, WRENCHES OR POWER TOOLS

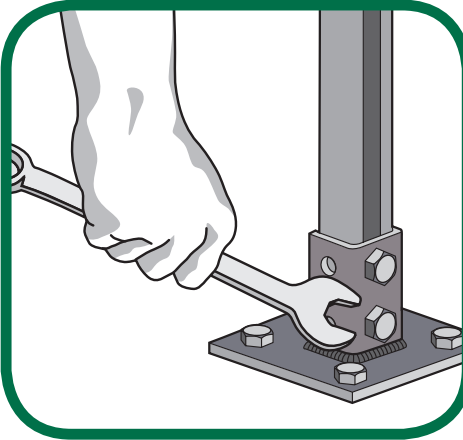
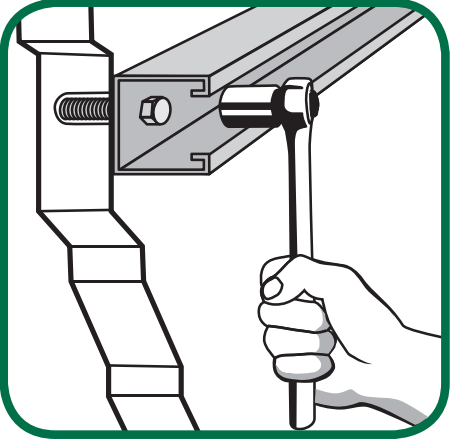

**NO DRILLING**

**NO WELDING**

**NO HASSLE**



# 5 Questions To Ask When Selecting The Right Strut For The Job

1

## GAUGE AND DEPTH



What minimum gauge (material thickness) and depth (profile size) are required for the job?

- ☐ 12 GAUGE (.097) ☐ 14 GAUGE (.071)
- $1\frac{5}{8}"$  X ☐  $1\frac{3}{16}"$  D  $1\frac{5}{8}"$  X ☐  $1\frac{3}{16}"$  D
- $1\frac{5}{8}"$  X ☐  $\frac{7}{8}"$  D  $1\frac{5}{8}"$  X ☐  $1\frac{5}{8}"$  D
- $1\frac{5}{8}"$  X ☐ 1" D
- $1\frac{5}{8}"$  X ☐  $1\frac{3}{8}"$  D
- $1\frac{5}{8}"$  X ☐  $1\frac{5}{8}"$  D
- $1\frac{5}{8}"$  X ☐  $2\frac{7}{16}"$  D
- $1\frac{5}{8}"$  X ☐  $3\frac{1}{4}"$  D

2

## LENGTH

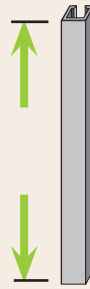

What channel length will best serve the end use?

- ☐ STANDARD 10' (Shorter runs for easy handling)
- ☐ STANDARD 20' (Typical for longer runs)
- ☐ 6' 8" (Typical for commercial joists distance)
- ☐ CUSTOM (6" TO 40')

3

## PERFORATION



What "hole pattern" (if any) will best serve the job function?

- ☐ OVAL SLOT (Half slot) [9/16" x 1-1/8" x 2" on ctr.]
- ☐ LONG SLOT (Elongated slot) [13/32" x 3" x 4" on ctr.]
- ☐ ROUND HOLE [9/16" DIAM x 1-7/8" on ctr.]
- ☐ KNOCK OUT [7/8" DIAM x 6" on ctr.]
- ☐ CONTINUOUS CONCRETE INSERT
- ☐ SOLID (No perforation)

4

## MATERIAL

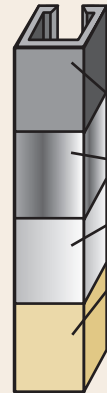

What "substrate" will best serve the job function?

- ☐ STEEL (Carbon steel, structural grade, 33,000 min yield)
- ☐ STAINLESS STEEL (304 OR 316)
- ☐ ALUMINUM
- ☐ FIBERGLASS

5

## FINISH



What type of finish or coating will best serve the construction?

- ☐ PRE-GALVANIZED (Continuous galvanized) - G90 zinc coating weight for cost-effectiveness long-term galvanic and barrier corrosion protection
- ☐ HOT DIPPED Galvanized (after fabrication heavy zinc) where aqueous or exterior applications require greater corrosion protection
- ☐ GREEN Powder or "e"-coated painted topical coating
- ☐ PVC COAT Heavy PVC coat for extended barrier protection or cosmetic effects (May PVC coat may be used over plain or galvanized)



- ☐ WIZCoat™ GALVANNEAL Paintable pregalvanized material requires no pre-treatment. Easily spray painted post-installation
- ☐ PLAIN Untreated, "plain" steel with no topical/ barrier coating
- ☐ GOLD Yellow zinc dichromated electro-galvanized
- ☐ CUSTOM COLORS Custom powder coating available in virtually any PMS color

# Proper Safety, Proper Tools, Proper Use and Installation

## Always Safety First

**Always** use proper protective gear.

**Always** install strut systems according to your engineer's recommendations and design.

**Always** adhere to published load factors.

**Always** use the proper tool for the job. Consult tool manufacturers recommendations for tasks associated with strut systems.

**Always**, Safety First.



**One call. One trusted source.**  
**gregorystrut.com 866-997-8788**

*Gregory Strut is a division of Gregory Industries*